

## CHARACTERISTICS

	STANDARD	AVAILABLE OPTIONS
<b>Technology</b>	Eccentric Disc Mouvex®	
<b>Maximum Flow rate at 1 cSt m<sup>3</sup>/h (GPM)</b>	11.7 (51.5)	
<b>Cubic capacity L (cu.in)</b>	0.406 (24.77)	
<b>Internal relief valve</b>	With	Double, Without
<b>Rotation</b>	Reversible	
<b>Ports</b>	Flanges	
<b>Heating</b>	None	Heating jacket
<b>Dimensions mm (in.)</b>	<b>A</b>	377 (14.84)
	<b>B</b>	325 (12.8)
	<b>C</b>	140 (5.51)
	<b>D</b>	300 (11.81)
	<b>E</b>	140 (5.51)
<b>Weight kg (lbs)</b>	41 (90.39)	

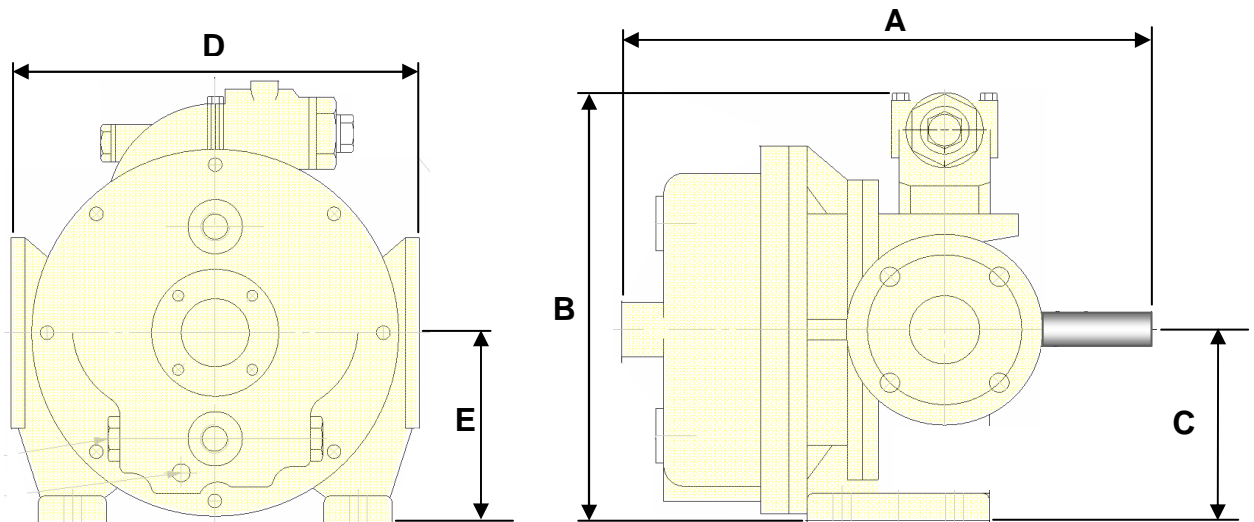

## OPERATING LIMITS

	STANDARD MATERIALS
Minimum temperature °C (°F)	-10 (14)
Maximum temperature °C (°F)	150 (302)
Maximum viscosity cSt (SSU)	15000 (69500)
Maximum differential pressure bar (psi)	3.5 (51)
Maximum speed (rpm)	500

## MATERIALS OF CONSTRUCTION

Part No	PART NAME	STANDARD MATERIALS	AVAILABLE OPTIONS
101	Main Body	Cast iron + Kanigen (1)	
201	Cylinder	Ni-Resist Cast iron	
301	Disc	Stainless steel	
401	Front cover	Cast iron + Kanigen (1)	
501	Shaft	Stainless steel	
	Bushings	Carbon	Bronze
	Static O-rings	FKM	EPDM
	Mechanical seal	Carbon/stainless steel/FKM	Carbon/stainless steel/FEP Bronze/stainless steel/FKM Bronze/stainless steel/FEP Tungsten carbide/Tung. C / FKM Tungsten carbide/Tung. C / FEP

